

0.9° 57mm 大力矩混合式步进电机

电机常规参数:

项目	参数
步距角	0.9°
步距角精度	±5% (整步, 空载)
电阻	±10%
电感	±20%
温升	80° C Max.(额定电流,两相通电)
环境温度	-20° C~+50° C
绝缘强度	100M Ω Min. ,500VDC
介电强度	500VAC 1 分钟
径向跳动	0.02Max. (450 g 负载)
轴向跳动	0.08Max. (450 g 负载)
径向负载	75N (从法兰 20mm 处)
轴向负载	15N



I 57mm 大力矩混合式步进电机

型号		额定电压	电流 /相	电阻 /相	电感 /相	静力矩	引出线根数	转子转动惯量	重量	保持力矩	长度
单出轴	双出轴	V	A	Ω	mH	kg-cm		g-cm ²	kg	kg-cm	mm
BL57STH41-1006MA	BL57STH41-1006MB	5.7	1	5.7	8.0	3.9	6	120	0.45	0.21	41
BL57STH41-2006MA	BL57STH41-2006MB	2.8	2	1.4	2.2	3.9	6				
BL57STH41-3006MA	BL57STH41-3006MB	1.9	3	0.63	1.0	3.9	6				
BL57STH41-2804MA	BL57STH41-2804MB	2	2.8	0.7	2.2	5.5	4				
BL57STH56-1006MA	BL57STH56-1006MB	7.4	1	7.4	17.5	9.0	6	300	0.7	0.4	56
BL57STH56-2006MA	BL57STH56-2006MB	3.6	2	1.8	4.5	9.0	6				
BL57STH56-3006MA	BL57STH56-3006MB	2.3	3	0.75	1.9	9.0	6				
BL57STH56-2804MA	BL57STH56-2804MB	2.5	2.8	0.9	4.5	12.0	4				
BL57STH76-1006MA	BL57STH76-1006MB	8.6	1	8.6	23	13.5	6	480	1	0.68	76
BL57STH76-2006MA	BL57STH76-2006MB	4.5	2	2.25	5.6	13.5	6				
BL57STH76-3006MA	BL57STH76-3006MB	3	3	1	2.6	13.5	6				
BL57STH76-2804MA	BL57STH76-2804MB	3.2	2.8	1.13	5.6	18.0	4				

I 尺寸

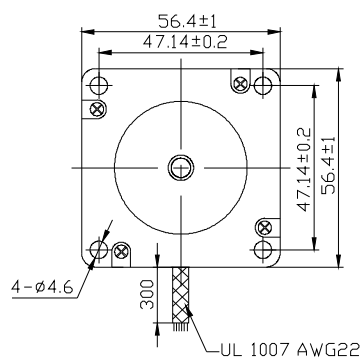
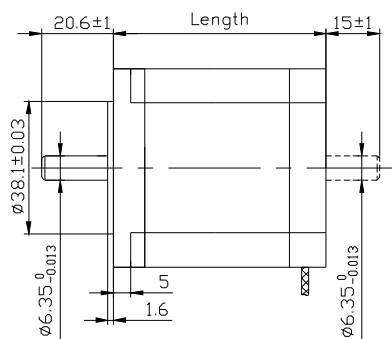

接线图

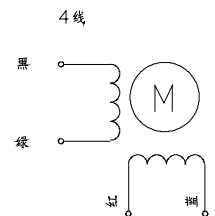
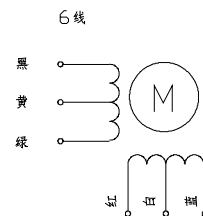

● 矩频曲线

BL57STH41-1006MA
电压: 30VDC; 电流1A /相 驱动器: HA335整步

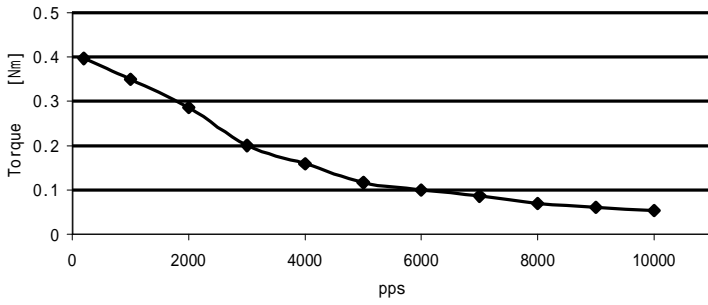

BL57STH41-2006MA
电压: 30V; 电流2A /相 驱动器: LW504整步

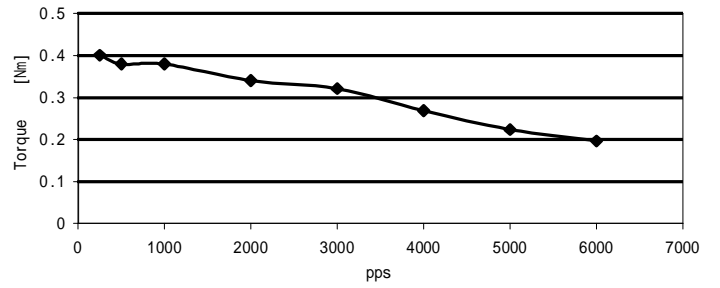

BL57STH41-3006MA
电压: 30VDC; 电流2.7A /相 驱动器: H860B, 整步

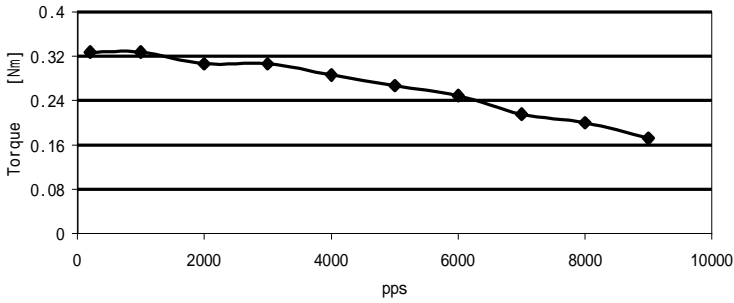

BL57STH41-2804MA
电压: 30VDC; 电流2.7A /相 驱动器: H860B, 整步

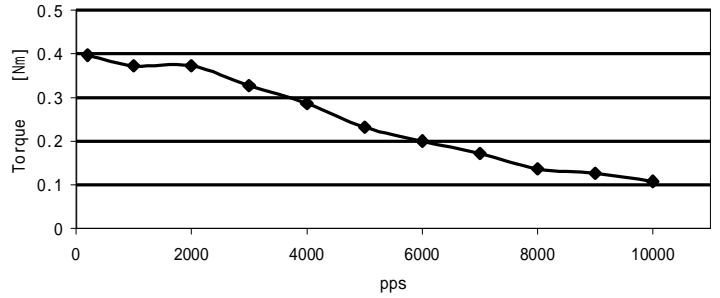

BL57STH56-1006MA
电压: 30VDC; 电流1A /相 驱动器: HA335, 整步

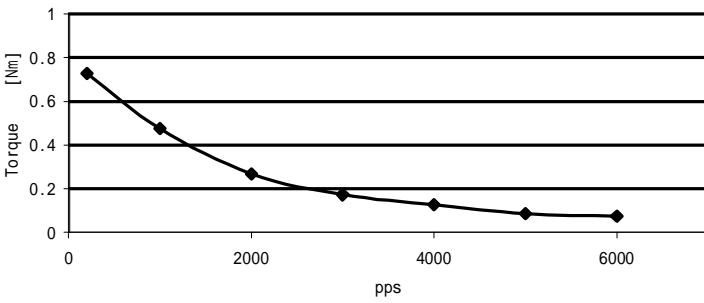

BL57STH56-2006MA
电压: 30VDC; 电流2.1A /相 驱动器: HA335, 整步

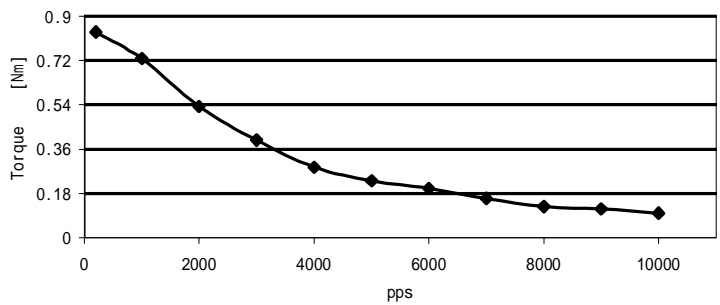

BL57STH56-3006MA
电压: 30VDC; 电流3A /相 驱动器: LW504, 半步

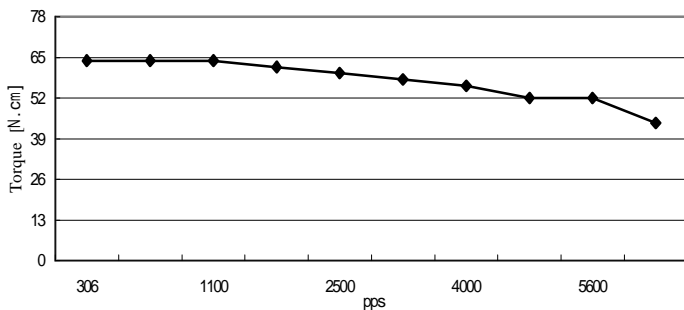

BL57STH56-2804MA
电压: 30VDC; 电流2.7A /相 驱动器: H860B, 整步

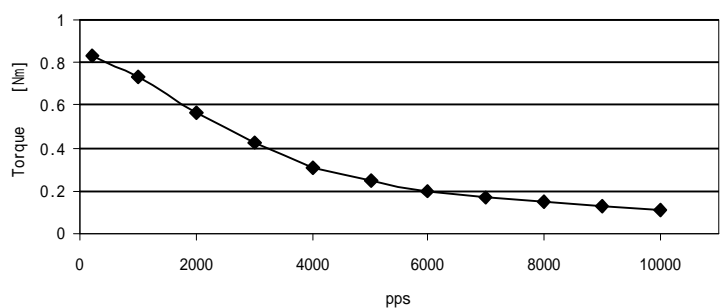

I 矩频曲线

BL57STH76-1006MA

电压: 30VDC; 电流1A /相 驱动器: LW504, 半步

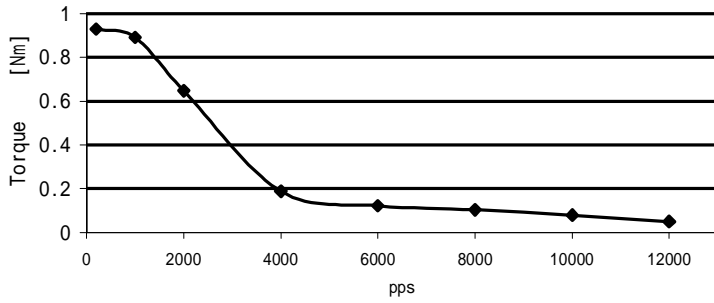

BL57STH76-2006MA

电压: 30VDC; 电流2.1A /相 驱动器: HA335, 整步

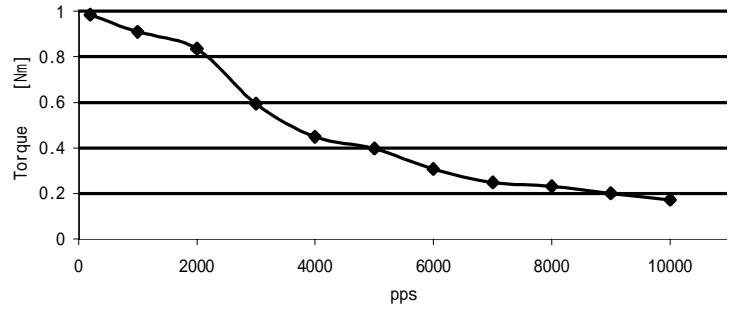

BL57STH76-3006MA

电压: 30VDC; 电流2.7A /相 驱动器: H860B, 整步

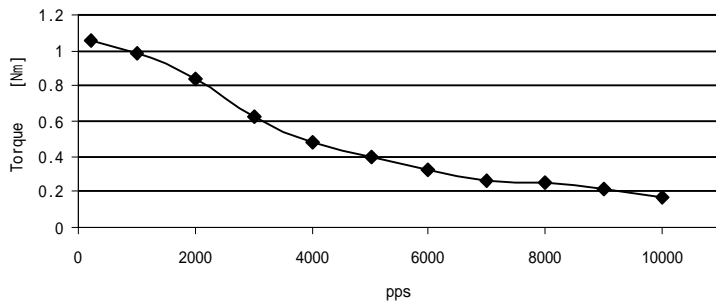

BL57STH76-2804MA

电压: 30VDC; 电流2.5A /相 驱动器: HA335, 半步

